

DRAWING No. 016512

ISSUE	CHANGE	DATE	CHK.
A		08.09	
B		01.12	FS

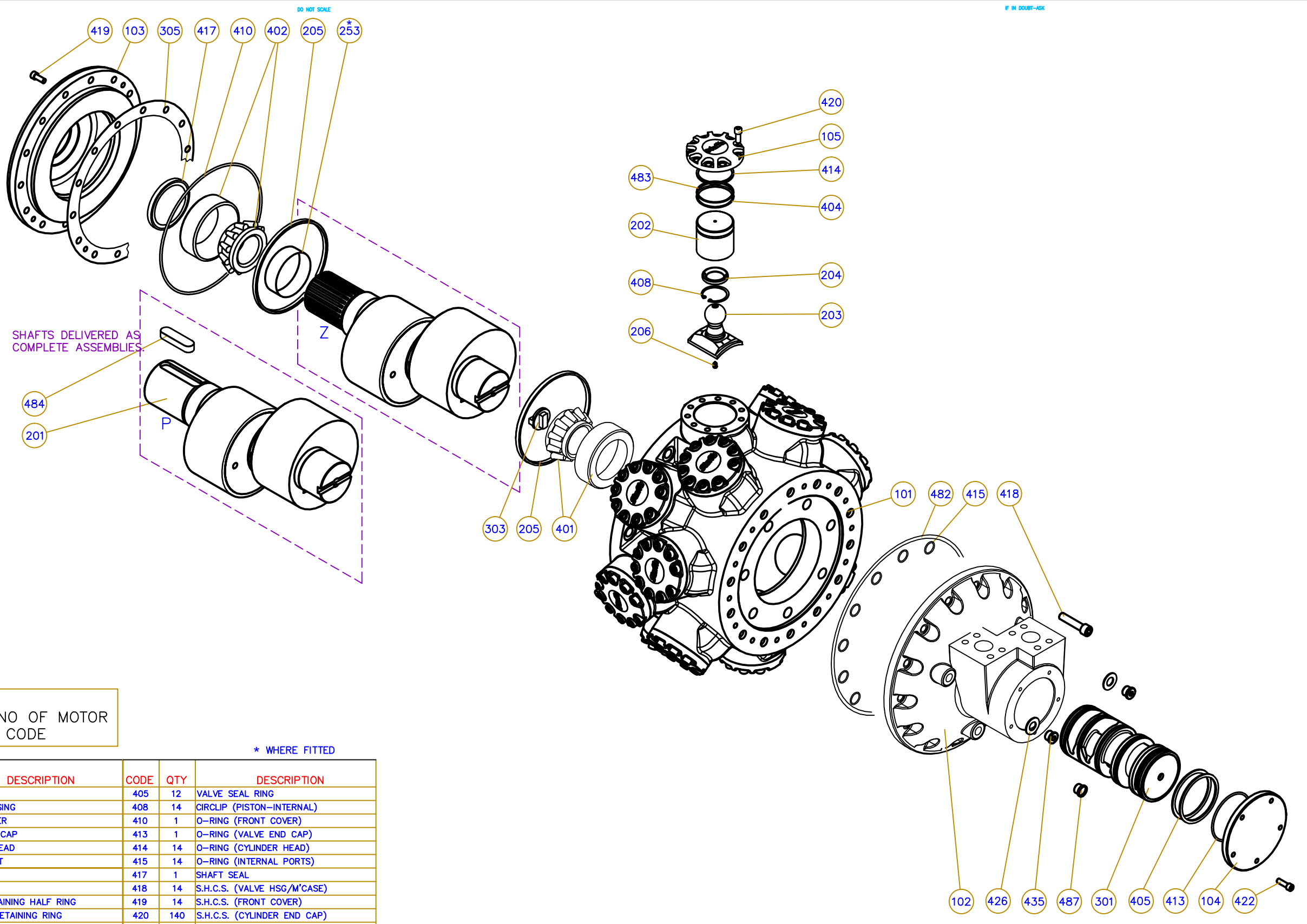

SHAFTS DELIVERED AS COMPLETE ASSEMBLIES

SPARES :
QUOTE SERIAL NO OF MOTOR
+ FULL MODEL CODE

* WHERE FITTED

CODE	QTY	DESCRIPTION	CODE	QTY	DESCRIPTION
101	1	MOTORCASE	405	12	VALVE SEAL RING
102	1	VALVE HOUSING	408	14	CIRCLIP (PISTON-INTERNAL)
103	1	FRONT COVER	410	1	O-RING (FRONT COVER)
104	1	VALVE END CAP	413	1	O-RING (VALVE END CAP)
105	14	CYLINDER HEAD	414	14	O-RING (CYLINDER HEAD)
201	1	CRANKSHAFT	415	14	O-RING (INTERNAL PORTS)
202	14	PISTON	417	1	SHAFT SEAL
203	14	CON-ROD	418	14	S.H.C.S. (VALVE HSG/M'CASE)
204	28	PISTON RETAINING HALF RING	419	14	S.H.C.S. (FRONT COVER)
205	4	CON-ROD RETAINING RING	420	140	S.H.C.S. (CYLINDER END CAP)
206	14	RESTRICTOR SCREW	422	5	S.H.C.S. (VALVE END CAP)
253 *	1	SHAFT SLEEVE	426	2	BONDED SEAL
301	1	VALVE SPOOL	435	2	DRAIN PLUG
303	1	OLDHAMS COUPLING	482	1	O-RING (VALVE HOUSING SURROUND)
305	-	SHIM (STEEL)	483	14	PISTON SEAL BACKING RING
401	1	REAR BEARING	484	1	CUSTOMER KEY
402	1	FRONT BEARING	487	1	PLASTIC PLUG
404	14	PISTON SEAL RING			

THIRD ANGLE PROJECTION	NAME	DATE	 Staffa Products <small>Emisette, Plymouth PL5 2SA www.kpm-eu.com</small>					
	DR. M.NORMAN	28.08.09						
	CHK.		GENERAL ASSEMBLY (FOR SPARES) HMB700 MOTOR					
	ENGR. APPL.							
	WT.		ALL TECHNICAL DATA DISCLOSED HEREIN IS THE PROPERTY OF KAWASAKI AND SHALL NOT BE USED BY OTHERS FOR MANUFACTURE, PROCUREMENT OR DISCLOSURE WITHOUT THE WRITTEN PERMISSION OF THE OWNER.					
	SIZE	A1	SCALE	NTS	DRAWING No.	016512	SHEET	1 of 1